

IGNITION SWITCH INSTALLATION-FRONT & REAR COCKPIT
PT-17, N2S-1, N2S-4, PT-13, N2S-5

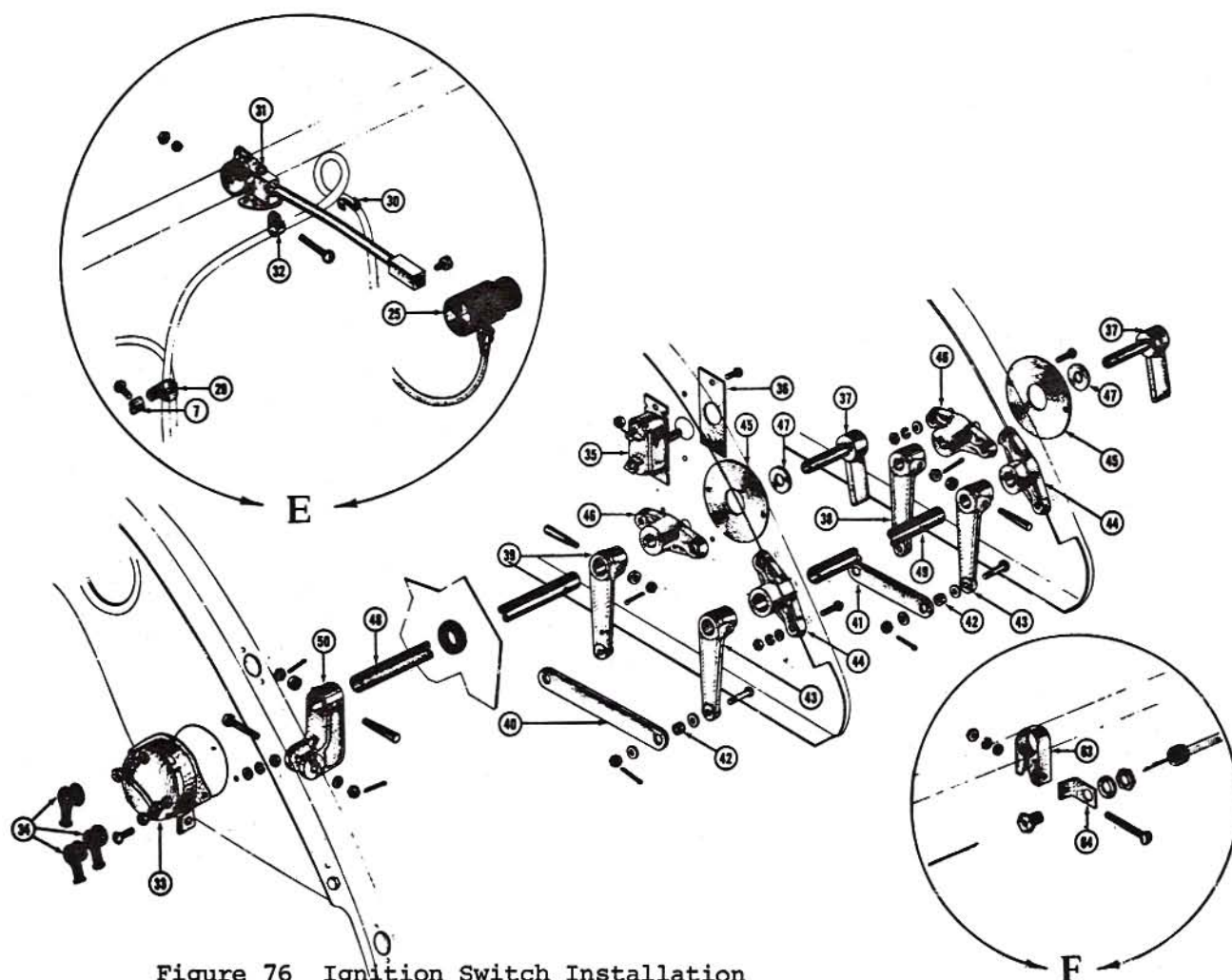

Figure 76 Ignition Switch Installation

Index

No.	Part No.	Description	Cond.
31	A75N1-3945	Bracket assy-instrument light mounting	N-S
32	S-101-D4	Clip-tube	F/N
33	E75N1-3941-1	Switch-ignition type A-7, original	N-S
33	E75-3941-2	A-9 switch-ignition, substitute	N-S
	Attach hdw.	2 ea. AN515-8-8, 2 ea. AN960-8, 2 ea. AN340-8, 2 ea. AN935-8	F/N
34	065-319	Spark plug nipple-ignition switch, 3 required	F/N
36	E75N1-3910	Name plate-oil dilution switch	F/N
	Attach hdw.	2 ea. AN515-8-7, 2 ea. AN365-832A	F/N
37	AG75-3905	Handle assy-ignition switch control, 2 required	FAA-PMA
38	75-3170-2	Lever-torque tube	N-S
39	75-3170-1	Lever-torque tube	N-S
	386-1-7	Pin-taper, threaded, 2 required	F/N
40	75-3140-3	Link-cock control arm connecting, front	N-P
41	75-3140-2	Link-cock control arm connecting, rear	N-P
42	S-205-9S	Replacement bushing-5/16" o.d. bearing	N-P
	Attach hdw.	4 ea. AN23-12, 8 ea. AN960-10	F/N
43	75-3170-3	Lever-torque tube	N-S
	386-1-6	Pin-taper, threaded, 75-3170-3 lever	F/N

IGNITION SWITCH INSTALLATION-FRONT & REAR COCKPIT, PT-17,N2S-1,N2S-4,PT-13,N2S-5 cont'd

Figure 76

Index

No.	Part No.	Description	Cond.
44	Attach hdw.	4 ea. AN975-3, 8 ea. AN320-3, 8 ea. AN380-2-2	F/N
	75-3913-1	Bearing-shaft, 2 required	N-P
45	Attach hdw.	4 ea. AN935-8, 4 ea. AN515-8-10, 4 ea. AN960-8, 4 ea. AN340-8	F/N
	A75N1-3905	Plate-ignition switch name, 2 required	F/N
46	75-3913-2	Bearing-shaft, 3/8" hole, 2 required	N-P
	Attach hdw.	4 ea. AN935-8	F/N
47	AG75-4513-21	Washer-special, 2 required	FAA-PMA
	Attach hdw.	4 ea. AN515-8-10, 4 ea. AN960-8, 4 ea. AN340-8	F/N
48	AG75-3910-1	Shaft-ignition switch torque, 25-12/32" L	FAA-PMA
49	AG75-3910-2	Shaft-ignition switch torque, 37- 5/8" L	FAA-PMA
	AN931-8-13	Grommet-elastic, 1 required	
50	75-3907	Attachment-ignition switch handle	N-S
	386-1-7	Pin-taper, threaded, 1 required	F/N
63	Attach hdw.	1 ea. AN975-3, 1 ea. AN320-3, 1 ea. AN3-10, 1 ea. AN960-10, 1 ea. AN310-3, 2 ea. AN380-2-2	F/N
	S-107-D51	Clamp-7/8" dia. tube	N-P
	Attach hdw.	1 ea. AN520-10-20, 1 ea. AN960-10, 1 ea. AN345-10	F/N
	A75-3900-KA7	Ignition switch installation kit with A-7 switch- less hardware	N-S
	A75-3900-KA9	Ignition switch installation kit with A-9 switch- less hardware	N-S