

Figure 73

Index

No.	Part No.	Description	Cond.
	75-3733	Installation-static ground	N-S
1	75-3752	Wire assy-static ground	N-S
2	75-3752-6	Support assy-static	N-S
3	75-3752-7	Wire assy-static	N-S
4	75-3752-3	Nut	N-S
	Attach hdw.	1 ea. AN526-1032-7, 1 ea. AN526-1032-8, 2 ea. AN365-1032A F/N	
Ref.	AG75-2382	Frame assy-fuselage cleanout door	FAA-PMA
Ref.	AG-2383	Door assy-fuselage cleanout door	FAA-PMA

INSTRUMENT PANEL & INSTRUMENT INSTALLATION PT-13D & N2S-5  
FRONT COCKPIT

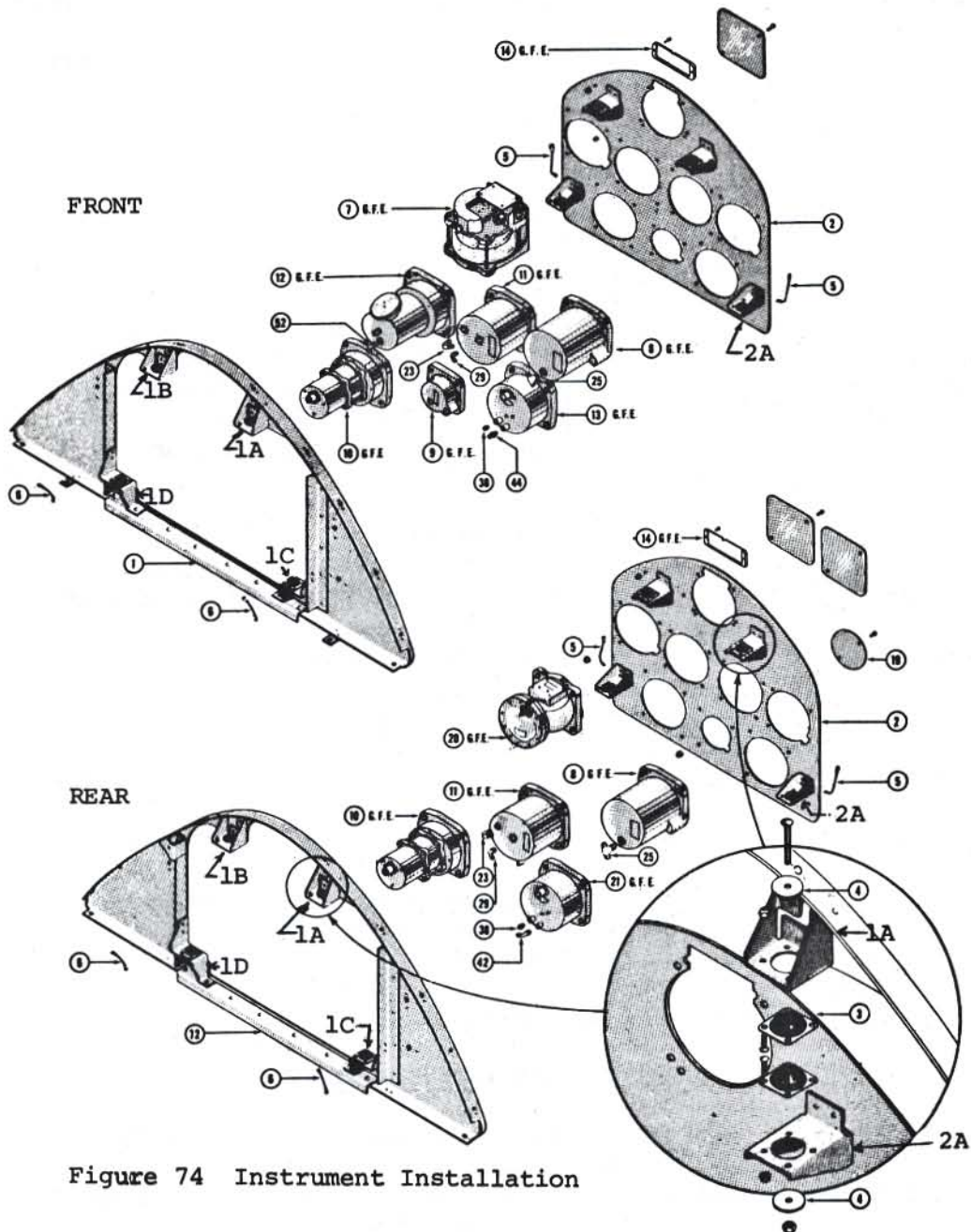

Figure 74 Instrument Installation

INSTRUMENT PANEL & INSTRUMENT INSTALLATION, PT-13D & N2S-5, FRONT COCKPIT cont'd

Figure 74

Index

No.	Part No.	Description	Cond.
	75-3801	Instrument panel assy-front, has AGE75N1-3811 base and AGE75N1-3804 floating panel assembled	N-P
	Attach hdw.	Front base to fuselage, 1 ea. AN3-15A lh side, 1 ea. AN23-26A rh side	F/N
1	E75N1-3811	Base-instrument panel front, this part shown in figure 74	N-P
2 & 3	E75N1-3804	Floating panel-instrument front, this part shown in figure 74	N-P
	AN8008-4	Isolator-instrument panels, 8 required	F/N
	Attach hdw.	16 ea. AN526-632-5, 16 ea. AN365-632A	F/N
1A	75-3841	Replacement bracket-upper left isolator support-instrument base	N-P
1B	75-3841-1	Replacement bracket-upper right isolator support-instrument base	N-P
1C	75-3840	Replacement bracket-lower left isolator support-instrument base	N-P
1D	75-3840-1	Replacement bracket-lower right isolator support-instrument base	N-P
2A	75-3809	Replacement bracket-floating panel front, isolator support, 4 required	N-P
	Attach hdw.	Base to floating panel 4 ea. AN515-8-24, 4 ea. AN365-832A	F/N
4	AG75-4513-16	Washer-special, base to floating panel front, 8 req.	FAA-PMA
5	3AJ8-8	Jumper-bonding, front floating panel, 2 required	F/N
6	2AJ8-8	Jumper-bonding, front base panel, 2 required	F/N
	E75-3806	Plate-3-1/8", instrument hole closing-optional	N-P
	Attach hdw.	4 ea. AN515B-8-8, 4 ea. AN365B-8-2A	F/N
7	88-C-800	Compass, B-16-front cockpit, original or Matte White dial	O/H/C
8	60-800	Altimeter-sensitive, C12 or 13, 7:00 knob, original or Matte White dial	O/H/C
9	60-1200	Clock-A-11 8 day, 7:00 knob, front cockpit	O/H/C
10	88-1-2500	Tachometer-electric, 0-4500 RPM, 3 pin connection original or Matte White dial	O/H/C
10	Mark "V"	Generator-electric tach indicator, 3 pin connection, front cockpit (not shown)	O/H/C
10	RT-10	Tachometer-hour recording, cable drive, front cockpit	F/N
10		Tach drive cable & housing assy-front cockpit, long	F/N
11	88-1-240	Air speed indicator- 0-300 mph, dial original or Matte White	O/H/C
12	88-1-3280	Turn & bank indicator-vac type, dial original or Matte White	O/H/C
13	88-U-600-8	B-7, 3-1 engine gauge unit-8' capillary, original dial, front cockpit	N-S
14	88-H-500	Holder, compass card	N-P
	Attach hdw.	2 ea. AN515B-8-4, 2 ea. AN365B-440	F/N
		Rate of climb-optional, 0-2000	O/H/C

REAR COCKPIT PT-13D & N2S-5

	75-3802	Instrument panel assy-rear, has AGE75N1-3812 base & AGE75N1-3804 floating panel assembled	N-P
	Attach hdw.	Instr. panel to fuselage, 1 ea. AN3-17A, 1 ea. AN3-16A, 2 ea. AN960-10, 2 ea. AN365-1032A	F/N