

PILOT SEAT & COMPONENT PARTS, R-670,PT-17,N2S-4 & R-680,PT-13,N2S-5 continued

Figure 71

Index

| No. | Part No. | Description | Cond. |
|---------|--------------|--|---------|
| 8 | AG75-3719-11 | Slide tube-pilot seat adjustment | FAA-PMA |
| | Attach hdw. | 1 ea. AN3-13A, 1 ea. AN365-1032A, 8 ea. AN4-14, 8 ea. AN310-4, 8 ea. AN380-2-2 | F/N |
| | B-14 | Seat belt assy-military type, nylon, 2 required | F/N |
| | B-15 | Shoulder harness assy-military type, nylon, 2 required | F/N |
| | Attach hdw. | 4 ea. AN24-13A, 4 ea. AN365-428A, 12 ea. AN960-416, 1 ea. AN960-10L, 1 ea. AN23-11, 1 ea. AN320-3, 1 ea. AN380-2-2 | F/N |
| 10 & 11 | AG75-3647 | Seat socket assy-lower, 4 required | FAA-PMA |
| | Attach hdw. | 8 ea. AN4-15, 8 ea. AN310-4, 8 ea. AN960-416, 8 ea. AN380-2-2 | F/N |

FLIGHT CONTROL PARKING LOCK ASSEMBLY & PARTS
R-670, PT-17, N2S-4 & R-680, PT-13, N2S-5

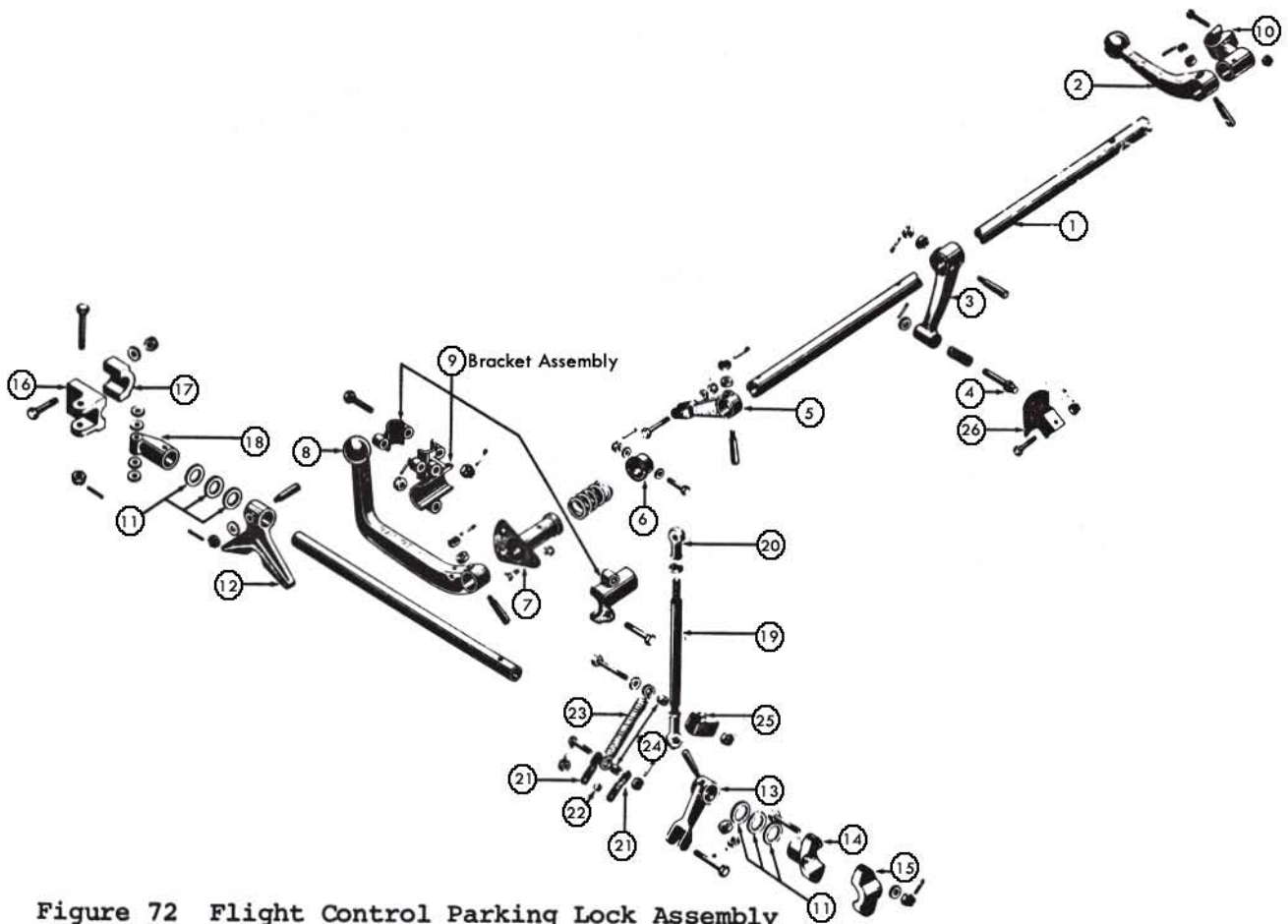

Figure 72 Flight Control Parking Lock Assembly

FLIGHT CONTROL PARKING LOCK ASSEMBLY & PARTS, R-670,PT-17,N2S-4 & R-680,PT-13, N2S-5

Figure 72

Index

| No. | Part No. | Description | Cond. |
|-----|-------------|---|---------|
| | 75-3650 | Installation-flight control lock, less hardware | FAA-PMA |
| 1 | 75-3651 | Shaft assy-parking lock side | N-P |
| 1 | AG75-3679 | Shaft-parking lock side | FAA-PMA |
| 2 | AG75-3682 | Handle-parking lock control rear | FAA-PMA |
| | 386-2-10 | Pin-taper, threaded, 1 required | F/N |
| | Attach hdw. | 1 ea. AN320-3, 1 ea. AN975-3, 1 ea. AN380-2-2 | F/N |
| 3 | 75-3656 | Lever-rudder parking lock | N-P |
| | 386-2-10 | Pin-taper threaded | F/N |
| 4 | 75-3671-1 | Pin-parking lock | F/N |
| | AG75-3675 | Spring-rudder parking lock compression | FAA-PMA |
| | Attach hdw. | 1 ea. AN380-2-2, 1 ea. AN960-416, 1 ea. AN320-3, 1 ea. AN975-3, 1 ea. AN380-2-2 | F/N |
| 5 | 75-3684 | Lever assy-parking lock control-upper | F/N |
| | AGS-275-16S | Replacement bushing 5/16 press. | FAA-PMA |
| | 386-2-10 | Pin-taper threaded | F/N |
| | Attach hdw. | 1 ea. AN320-3, 1 ea. AN975-3, 1 ea. AN380-2-2 | F/N |
| 6 | 75-3665-1 | Bearing-parking lock side shaft | N-P |
| | AG75-3674 | Spring-side shaft compression | FAA-PMA |
| | Attach hdw. | 1 ea. AN3-12, 1 ea. AN310-3, 1 ea. AN380-2-2, 2 ea. AN960-10 | F/N |
| 7 | 75-3666 | Bearing assy-parking lock side shaft front end | N-P |
| 8 | AG75-3735 | Handle assy-parking lock control front | FAA-PMA |
| | 75-3671-2 | Pin-parking lock | N-S |
| | 386-2-10 | Pin-taper threaded | F/N |
| | Attach hdw. | 1 ea. AN320-3, 1 ea. AN975-3, 1 ea. AN380-2-2, 1 ea. AN3-5, 1 ea. AN310-3, 1 ea. AN380-2-2 | F/N |
| 9 | 75-3715 | Bracket assy-parking lock side shaft bearing | N-S |
| | 75-3715-6 | Bracket assy-inner third | N-S |
| | 75-3715-7 | Bracket assy-middle third | N-S |
| | 75-3715-8 | Bracket assy-outer third | N-S |
| | Attach hdw. | 4 ea. AN4-13, 4 ea. AN310-4, 4 ea. AN380-2-2 | F/N |
| 10 | 75-3668 | Bearing assy-parking lock side shaft rear end | N-P |
| | Attach hdw. | 1 ea. AN3-14, 1 ea. AN310-3, 1 ea. AN380-2-2 | F/N |
| 11 | 75-3716 | Washer-shim, 6 required | N-P |
| | 76-3652 | Shaft assy-parking lock bottom | N-P |
| | AG75-3680 | Shaft-parking lock bottom | FAA-PMA |
| 12 | AG75-3662 | Fork-elevator push pull tube parking lock | FAA-PMA |
| | 75-3717 | Pin-special taper | N-P |
| | Attach hdw. | 1 ea. AN320-3, 1 ea. AN960-416, 1 ea. AN380-2-2 | F/N |
| 13 | AG75-3660 | Lever assy-parking lock control | F/N |
| | AGS-275-16S | Replacement bushing-flanged, 5/16" press | FAA-PMA |
| | 386-2-9 | Pin-taper threaded | F/N |
| | Attach hdw. | 1 ea. AN320-3, 1 ea. AN975-3, 1 ea. AN380-2-2 | F/N |
| 14 | 75-3658-1 | Bearing-parking lock bottom shaft, left end | N-P |
| 15 | 75-3658-2 | Bearing-parking lock bottom shaft, left end (cap) | N-P |
| | Attach hdw. | 2 ea. AN4-16, 2 ea. AN310-4, 2 ea. AN960-416, 2 ea. AN380-2-2 | F/N |
| 16 | 75-3654-1 | Support-parking lock bottom shaft end bearing | N-P |
| 17 | 75-3654-2 | Support-parking lock bottom shaft end bearing (cap) | N-P |
| | Attach hdw. | 2 ea. AN4-17, 2 ea. AN310-4, 2 ea. AN380-2-2, 2 ea. AN960-416 | F/N |
| 18 | 75-3673 | Bearing-parking lock bottom shaft right end | N-P |
| | Attach hdw. | 1 ea. AN4-22, 1 ea. AN310-4, 1 ea. AN960-416, 1 ea. AN380-2-2 | F/N |

FLIGHT CONTROL PARKING LOCK ASSEMBLY & PARTS, R-670,PT-17,N2S-4 & R-680,PT-13,N2S-5

Figure 72

Index

| No. | Part No. | Description | Cond. |
|-----|-------------|--|---------|
| 19 | AG75-3677 | Rod assy-parking lock control | FAA-PMA |
| 19 | AG75-3677-2 | Rod-parking lock control, less bearings | FAA-PMA |
| 20 | REB-3N | Rod end bearing-AG75-3677-2 rod, 2 required | F/N |
| | Attach hdw. | 2 ea. AN316-4, 1 ea. AN3-15, 1 ea. AN3-14, 2 ea. AN310-3, 2 ea. AN960-10, 2 ea. AN380-2-2 | F/N |
| 21 | 75-3711-2 | Strap-flying hoop retracting cord, 2 required | N-S |
| 22 | 75-3687 | Spacer-special bolt | N-S |
| 23 | 75-3686 | Spring, parking lock | N-P |
| | Attach hdw. | 1 ea. AN23-9, 1 ea. AN320-3, 1 ea. AN380-2-2 | F/N |
| 24 | S-253-12 | Spacer-3/16" bolt | N-P |
| 25 | S-110-51 | Clamp- 1-1/4" dia. tube | N-P |
| | Attach hdw. | 1 ea. AN960-10, AN3-20, 1 ea. AN310-3 | F/N |
| 26 | 75-3670 | Catch assy-rudder parking lock | N-P |
| | Attach hdw. | 1 ea. AN3-12, 1 ea. AN310-3, 1 ea. AN380-2-2 | F/N |
| | 75-3737 | Placard & bracket assy-flight control park lock front | N-P |
| | 75-3672-2 | Placard & bracket assy-flight control park lock rear | N-P |
| | 75-3746 | Placard only-flight control lock instr. | N-P |

STATIC GROUND INSTALLATION, R-670, PT-17, N2S-4 & R-680, PT-13, N2S-5

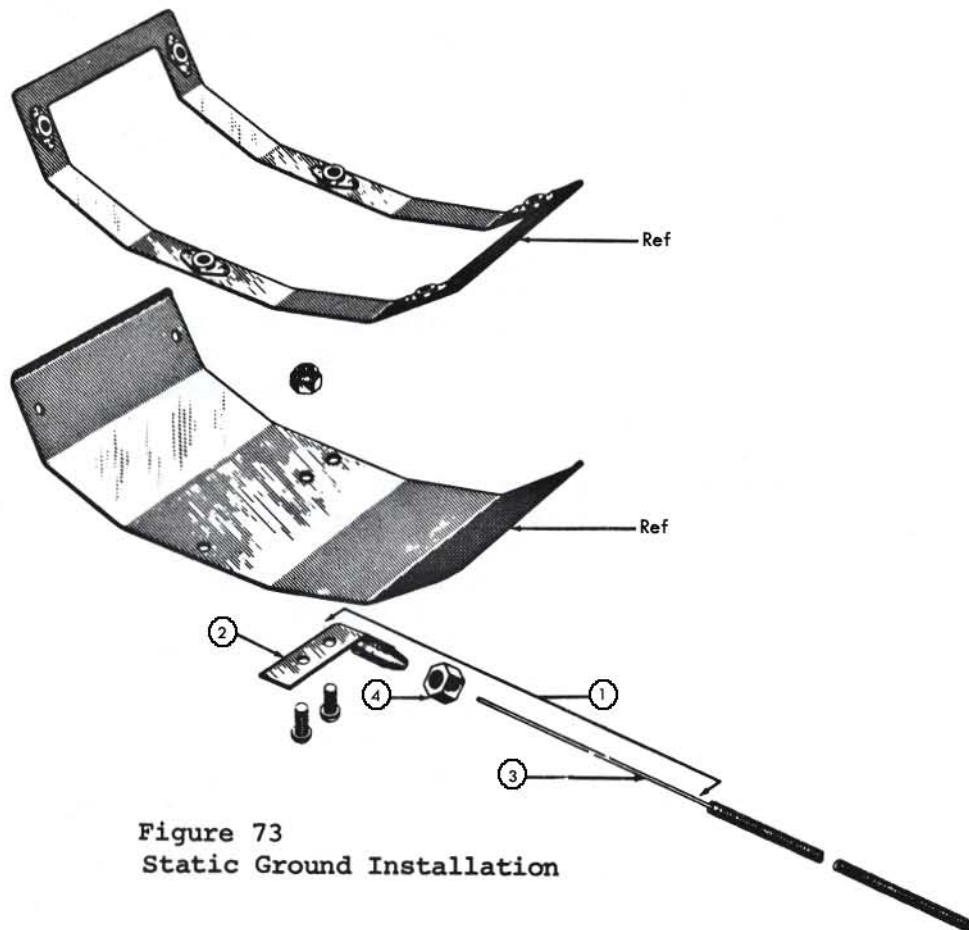

Figure 73
Static Ground Installation