

Figure 71
Pilot's Adjustable Seat
Assembly

Index

No.	Part No.	Description	Cond.
	73-3602	Aluminum pilot seat (AN7505)	
1	B75-3609	Clip-lower map case support	N-S
	Attach hdw.	2 ea. AN520-10-28, 2 ea. AN365-1032A	F/N
2	S-108-D51	Clamp-1" dia. tube, B75-3625-1 channel, 2 required	N-P
3	B75-3625-1	Channel-map case report	N-S
2	S-108-D51	Clamp-1" dia. tube-lower part of tube, 2 required	N-P
	Attach hdw.	2 ea. AN520-10-36, 2 ea. AN365-1032A, 3 ea. AN960-10	F/N
5	E75N1-3603	Hanger-seat spring adjustment, 2 required	N-P
6	E75N1-3602	Spring-seat adjustment, 2 required per seat	N-P
6	75-3619	Cord assy-elastic, seat adjustment, 1 req.per seat	N-P
7	AG75-3719-9	Clamp half assy-upper slide tube, 2 req. per seat	FAA-PMA

PILOT SEAT & COMPONENT PARTS, R-670,PT-17,N2S-4 & R-680,PT-13,N2S-5 continued

Figure 71

Index

No.	Part No.	Description	Cond.
8	AG75-3719-11	Slide tube-pilot seat adjustment	FAA-PMA
	Attach hdw.	1 ea. AN3-13A, 1 ea. AN365-1032A, 8 ea. AN4-14, 8 ea. AN310-4, 8 ea. AN380-2-2	F/N
	B-14	Seat belt assy-military type, nylon, 2 required	F/N
	B-15	Shoulder harness assy-military type, nylon, 2 required	F/N
	Attach hdw.	4 ea. AN24-13A, 4 ea. AN365-428A, 12 ea. AN960-416, 1 ea. AN960-10L, 1 ea. AN23-11, 1 ea. AN320-3, 1 ea. AN380-2-2	F/N
10 & 11	AG75-3647	Seat socket assy-lower, 4 required	FAA-PMA
	Attach hdw.	8 ea. AN4-15, 8 ea. AN310-4, 8 ea. AN960-416, 8 ea. AN380-2-2	F/N

FLIGHT CONTROL PARKING LOCK ASSEMBLY & PARTS
R-670, PT-17, N2S-4 & R-680, PT-13, N2S-5

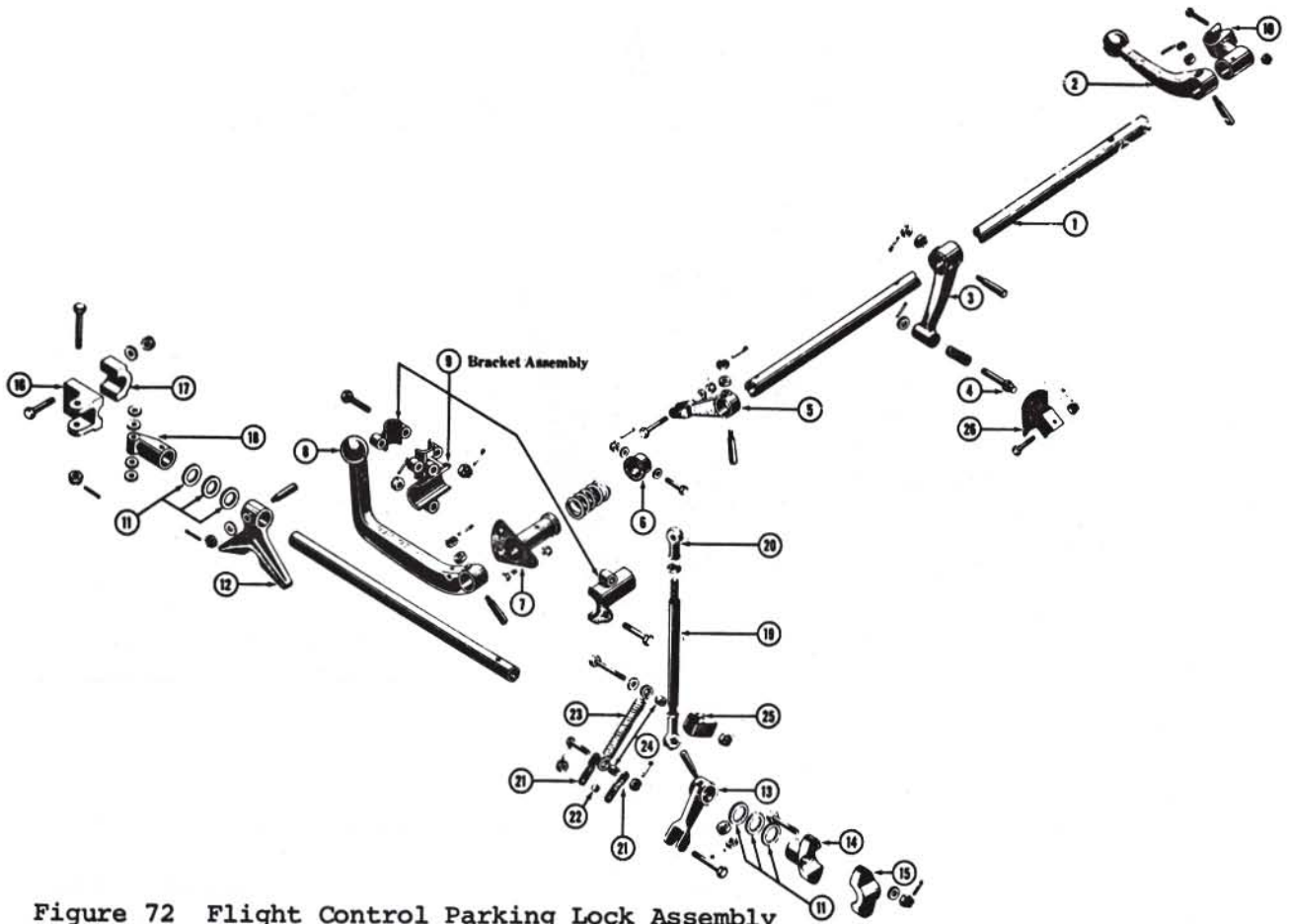

Figure 72 Flight Control Parking Lock Assembly