

TAILWHEEL POST ASSEMBLY COMPONENT PARTS

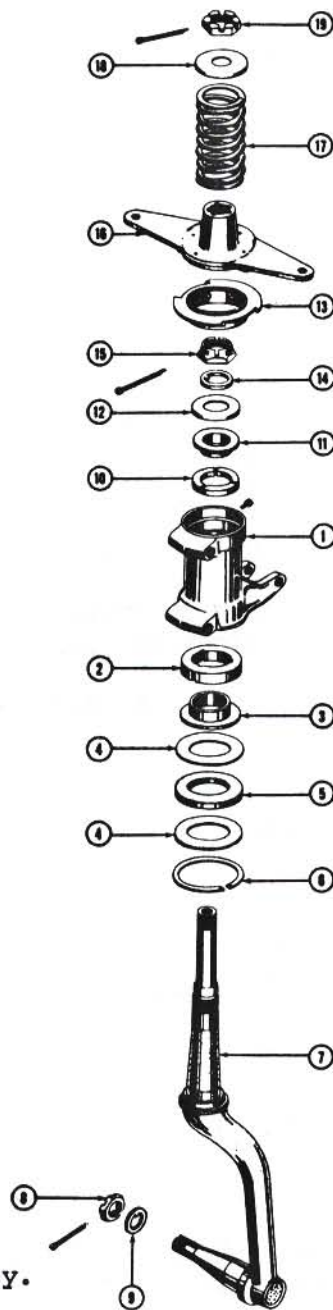

Figure 33
Tailwheel Post Assy.

Index

No.	Part No.	Description	Cond.
1	AG75-2703	Tail post casting-tailwheel knuckle	FAA-PMA
	AGS-227-120S	Replacement bushing, long-tail post casting, 2 req.	FAA-PMA
	AGS-227-38S	Replacement bushing, short-tail post casting, 2 req.	FAA-PMA
2	AG75-2711	Bearing-friction, tailwheel spindle lower	FAA-PMA
3	AG75-2711-1	Plate-thrust friction	FAA-PMA
4	107-S-7	Washer-felt retainer, 2 required	N-P
5	108-S-9	Washer-felt	N-P
6	109-S-7	Ring-snap, felt washer retainer	N-P
7	57593	Knuckle-tailwheel	N-S
7	57593	Knuckle-tailwheel	Recond.
8	AN320-10	Nut-shear, tailwheel axle	F/N
9	110-S-9	Washer-tailwheel axle	N-P

TAILWHEEL POST ASSEMBLY COMPONENT PARTS continued

Figure 33

Index

No.	Part No.	Description	Cond.
	AN380-4-5	Cotter pin, tailwheel axle nut	F/N
10	A75N1-4511-1	Bearing-tailwheel spindle upper	F/N
11	A75N1-4511-2	Race-tailwheel spindle upper	F/N
12	51533	Cup-grease retainer	N-P
13	AG55184	Support-steerable mast	FAA-PMA
	AN502-10-4	Screw-drilled head, AG55184 support attach, 3 req.	F/N
14	110-S-7	Washer-upper bearing retainer	FAA-PMA
15	111-S-8	Nut-upper bearing retainer	N-S
	AN380-4-6	Cotter pin - 111-S-8 nut	F/N
16	AG52901	Mast assy-steerable	FAA-PMA
	AG52901-1	Replacement friction plate for AG52901	FAA-PMA
17	52903	Spring-tailwheel post	N-P
18	51489	Washer cup-spring retainer	N-P
19	AN320-12	Nut-shear, 52903 spring retainer	N-P
	AN380-4-6	Cotter pin-AN320-12 nut	F/N
20	AG-114	Spline shaft-steerable	FAA-PMA
	AG-114P	Lock pin for AG-114 shaft	N-P