

TAILWHEEL ASSEMBLY PARTS-STEARABLE

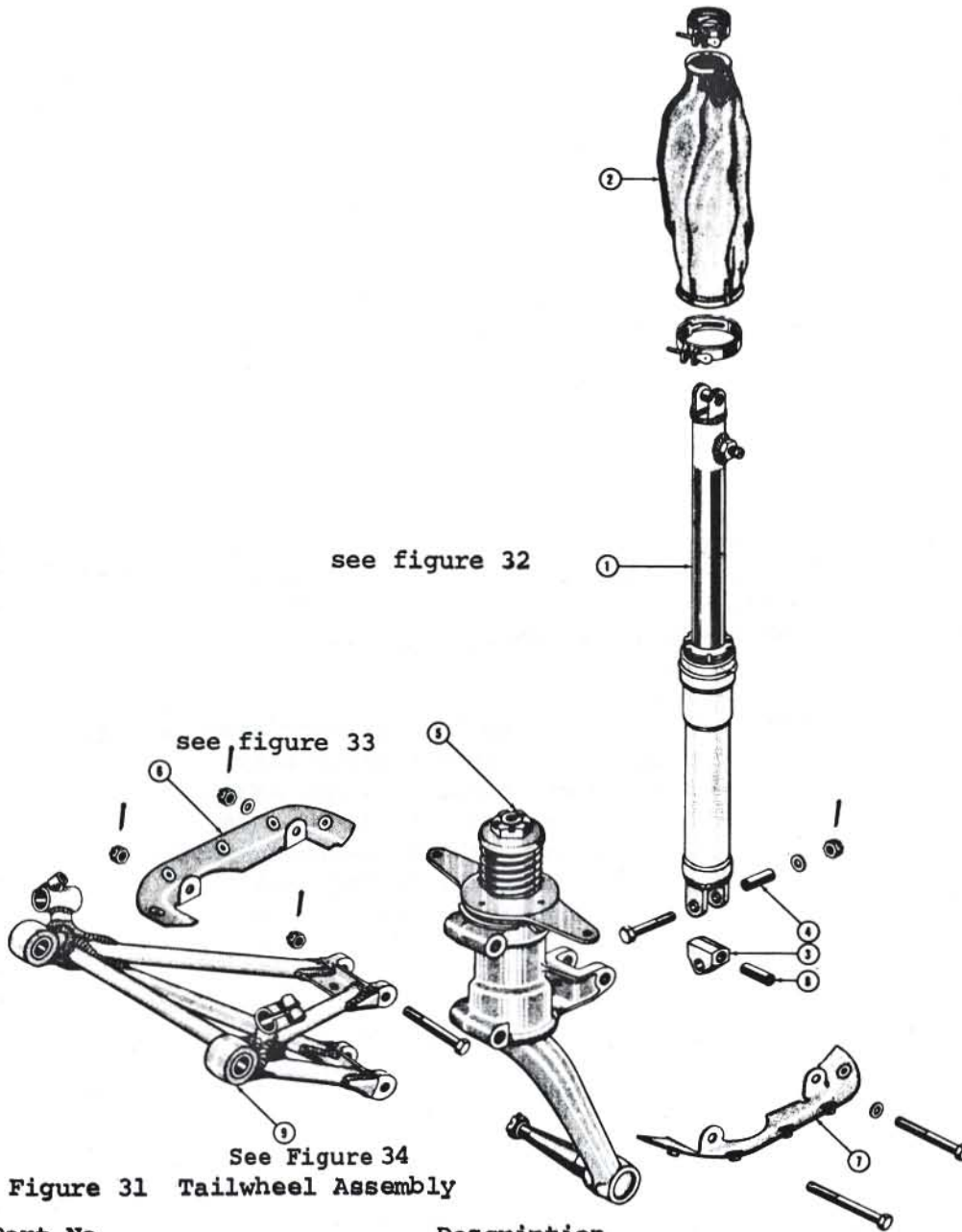

Figure 31 Tailwheel Assembly

Index No.	Part No.	Description	Cond.
1	75-2702	Tail strut assy-original	Recond.
2	75-2708	Boot assy-tailwheel shock strut	N-S
3	75-2715	Block-universal tailwheel shock strut	N-S
4	AG75-2702M4	Bushing-tailwheel shock strut, upper & lower, 2 req.	FAA-PMA
	AN5-14	Bolt-lower tail strut to 75-2715	F/N
	AN5-26	Bolt-lower tail strut to AG75-2703	F/N
	AN960-516	Washer-lower tail strut to AG75-2703	F/N
	AN310-5	Nut-lower tail strut to AG75-2703	F/N
	AN380-2-2	Cotter pin-lower tail strut to AG75-2703	F/N
5	75-2742	Tailpost assy-steerable	N-P
6	75-2349-1	Bracket, rh-tailwheel boot	N-P
7	75-2349-2	Bracket, lh-tailwheel boot	N-P
	Attach hdw.	2 ea. AN5-26, 2 ea. AN310-5 & 4 ea. AN960-516	F/N

TAILWHEEL ASSEMBLY PARTS-STEARABLE continued

Figure 31

Index

No.	Part No.	Description	Cond.
8	AG-S-131-1	Bearing-oiless, 75-2715 block	FAA-PMA
9	AG75-2704	Trunion assy-tailwheel	FAA-PMA
	AG75-2717	Bushing-steel, trunion, 2 required	FAA-PMA
	AGS-131-4	Bushing-oiless, trunion, 2 required	FAA-PMA
	AN5-25	Bolt-trunion to top tailpost casting, 1 required	F/N
	AN5-14	Bolt-trunion to fuselage, 2 required	F/N

TAILWHEEL SHOCK ABSORBER ASSEMBLY, COMPONENT PARTS

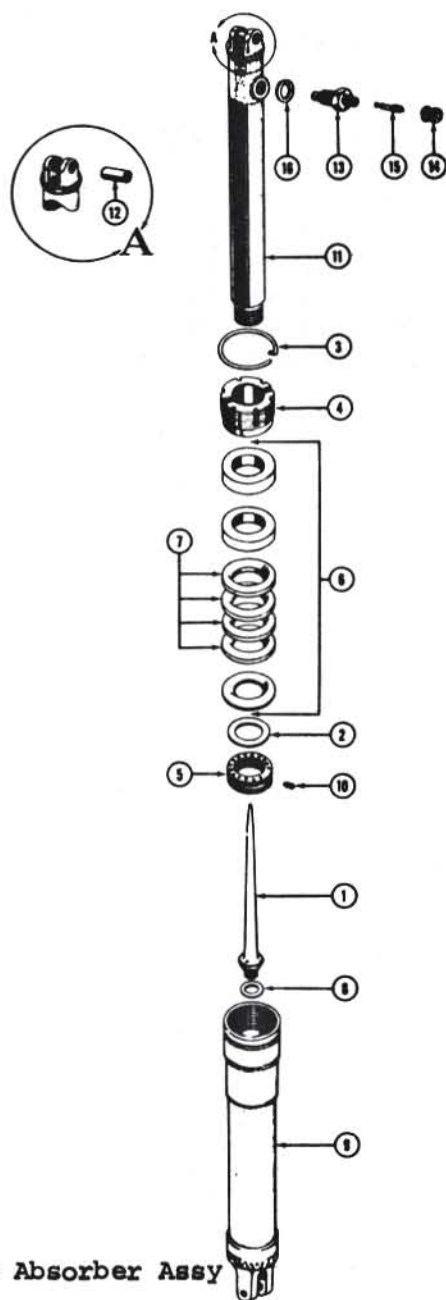

Figure 32
Tailwheel Shock Absorber Assy